

STELLAR 12X9 PIVOT DOOR SHOWERS

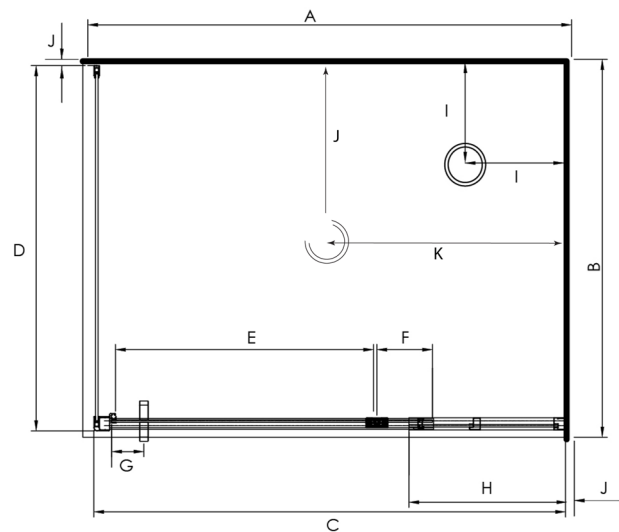

Pictured Above - Stellar Capricorn
Left Hand Orientated Tray
Silva Door, Moulded Wall

SKU 248542



DESCRIPTION

The Stellar rectangular range of pivot door showers can be purchased as a complete shower cubicle including Acrylic Tray, Wall Liner and Door Pack.

The Door pack and Tray can also be purchased as individual items for installation on a tiled wall and/or tiled floor.

SEE TILE SHOWER LAYOUT FOR SETOUT DIMENSIONS.

The door opening direction is reversible.

FEATURES

- Available in Silva or White
- Low profile tray with 40mm upstand
- 1950mm high door
- Total OVERALL height 2020mm
- 6mm Safety Glass compliant to AS/NZ S2208 Safety Standard
- Door is reversible (flip to fit)
- Extrusions allow for adjustment to wall and floor
- High quality hardware
- Door available on 900 side (surcharge applies).

LEGEND

Dimension	Description	Capricorn Shower Size	
		1200 x 900 1200 Door	1200 x 900 900 Door
A	Tray External Length Dimension	1200mm	1200mm
B	Tray External Width Dimension	900mm	900mm
C	Door Frame Dimension	1170mm	870mm
D	Return Panel Dimension	870mm	1170mm
E	Door Opening Dimension	640mm	640mm
F	Centre of Pivot Block to Edge of Door Glass	138mm	138mm
G	Centre of Handle to Edge of Door	80mm	80mm
H	Return Glass Panel Dimension	389mm	N/A
I	Waste position (CNR)	250mm	250mm
J	Waste position (CW)	450mm	600mm
K	Waste position (CW)	600mm	450mm

ORDERING CODES

Product	SKU CODE			
	1200 x 900 LH 1200mm Door	1200 x 900 RH 1200mm Door	1200 x 900 LH 900mm Door	1200 x 900 RH 900mm Door
Complete Cubicle Flat Wall White Pivot Door	248535	248536	248535 *	248536 *
Complete Cubicle Flat Wall Silva Pivot Door	248540	248539	248540 *	248539 *
Complete Cubicle Moulded Wall** White Pivot Door	248538	248537	248538 *	248537 *
Complete Cubicle Moulded Wall** Silva Pivot Door	248542	248541	248542 *	248541 *
Centre waste option for tray (please add additional SKU)	119561	119561	119561	119561
Flat Tray Only (Corner Waste)	TFS12X9LHCNR	TFS12X9RHCNR	TFS12X9LHCNR	TFS12X9RHCNR
Flat Tray Only (Centre Waste)	TFS12X9LHCW	TFS12X9LHCW	TFS12X9LHCW	TFS12X9LHCW
Flat 2 Sided Wall Liner Only White 1950mm High	LB12X9FW2S195	LB12X9FW2S195	LB12X9FW2S195	LB12X9FW2S195
Moulded** 2 Sided Wall Liner Only White 1950mm high	LB12X9MW2S195	LB12X9MW2S195	LB12X9MW2S195	LB12X9MW2S195
Pivot Door and Return Only White (reversible opening)	D12DX9RWH195	D12DX9RWH195	D9DX12RWH195	D9DX12RWH195
Pivot Door and Return Only Silva (reversible opening)	D12DX9RSI195	D12DX9RSI195	D9DX12RSI195	D9DX12RSI195

* Please specify 900 Door / 1200 Return on Order (surcharge applies)
 **Moulded Wall on Back Wall Standard (1200 side)

WARRANTY INFORMATION

All bathroomware products supplied by Fibre Systems carry our Quality Assurance and Product Warranty. We use the highest quality materials available and manufacture these in accordance with New Zealand specifications and requirements to ensure that all products are fit for the intended purpose for which they are designed. Our customer's peace of mind is of paramount importance to us.

Warranty Periods

Baths	10 years
Showers	10 years
Shower Screens and Doors	10 years
Silva and White Coatings	10 years
E-Line + Squareline + Dezine Showers	5 years
Black Coatings	5 years
Aquaknight Easy Clean Wastes	7 years
Accessories	2 years



Warranty Exclusions

The product must be installed according to the instructions supplied.
 The water supply temperature applied to the product must not exceed 55 degrees Celsius.
 All cleaning and cleaning products must be in accordance with our cleaning instructions and guidance.
 Commercial Applications (where products are installed in a building where occupancy is via a commercial arrangement i.e. a rental property, hotel, hostel etc) are restricted to a 2 year warranty on all products.

CLEANING AND MAINTENANCE

Please refer to our cleaning instructions document for guidance, available on our website

In accordance with our continuous product development programs, Fibre Systems sizes and specifications outlined in these specifications are subject to change without notice.

Information detailed in this technical sheet represents the actual product available at the time of printing this sheet. For the latest version of this technical sheet please visit www.stellarshowers.co.nz or contact your nearest Mitre 10 store to confirm any questions prior to purchase.