

SQUARELINE RECTANGULAR SHOWERS

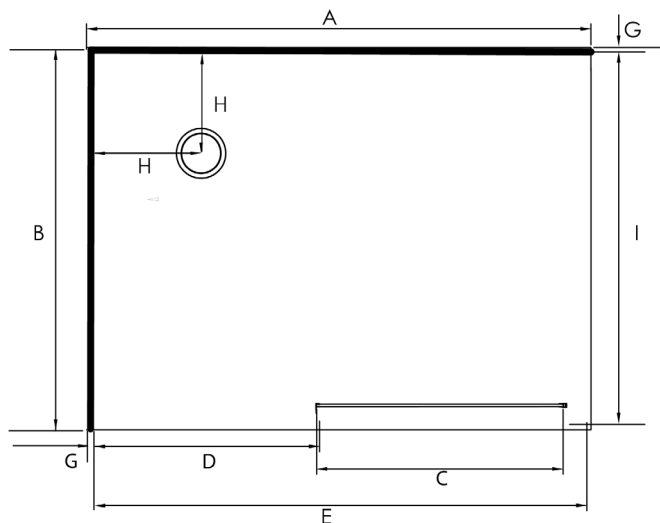

Pictured Above - SQUARELINE 12x8 Rectangular Shower RH
Tray SKU 248466

DESCRIPTION

The Squareline range of Showers can be brought as a complete Shower Cubicle including Acrylic Tray, Wall Liner and Door Pack.

The Door Pack and Tray can also be brought as individual items for installation on a tiled floor and/or wall.

FEATURES

- Low profile tray with 40mm upstand
- 1900mm high glass
- Total OVERALL height 1970mm
- Magnetic strip on closing edge of doors
- Door 6mm AS/NZS2208 Safety Glass
- White Frame

LEGEND

Dimension	Description	Shower Size
		1200x800
A	Tray Length External Dimension	1200mm
B	Tray Depth External Dimension	800mm
C	Door Opening Dimension +/- 10mm	560mm
D	Glass Return Panel Dimension	542mm
E	Door Frame Overall Dimension	586mm
F	Gib Board + Glue + Liner Thickness	13.00mm
H	Waste Position Depth + Width	250mm

ORDERING CODES

Description	Shower Size
	12x8
Complete Cubicle Silva Flat Wall LH	283976
Complete Cubicle Silva Flat Wall RH	283977
Complete Cubicle Silva Flat Wall ALCOVE	283978
Tray Only Corner Waste White LH	TFS12X8LHCNR
Tray Only Corner Waste White RH	TFS12X8RHCNR
Liner Only Flat Wall 1900mm High White	LBSLEL12X8FW2S19
Rectangular Door Pack Complete 1900mm High Silva LH/RH	DES12DX8RSI19

WARRANTY INFORMATION

We use the highest quality materials available and manufacture these in accordance with New Zealand specifications and requirements to ensure that all products are fit for the intended purpose for which they are designed. Our customers peace of mind is of paramount importance to us.

Warranty Periods

Showers	5 years
Shower Screens and Doors	5 years

Warranty Exclusions

The product must be installed according to the instructions supplied.
The water supply temperature applied to the product must not exceed 55 degrees Celsius.
Commercial applications are restricted to a 1 year warranty on all products.



CLEANING AND MAINTENANCE

Bathroom products are used often and the following is our suggestion on how to clean and care for them.

Shower Wall

We use Durosan premium quality sanitaryware grade Acrylic. It is, by design, very robust and chemical resistant. A soft damp cloth with non-abrasive cleaners should be used. Use only non-abrasive cleaners that are recommended for acrylic products.

Shower Tray and Bath

We manufacture our Shower Trays and Baths using a Solid Acrylic Surface. Most other shower trays are manufactured using a veneer acrylic surface. The great advantage is that small scratches can be removed easily by using fine cutting compound. Again, the same basic cleaning methods as the wall are recommended.

Shower Doors and Glass

All glass is compliant to AS/NZS 2208. We suggest that the glass surfaces are wiped down or squeegeed following use to remove excess water. For best results use a trusted glass cleaner.

Metal Framework

Should be cleaned using a soft damp cloth with non-abrasive cleaner. Note that on round showers, the bottom rollers are easy release for ease of cleaning. If chemical spray cleaners are used, avoid direct contact with the rollers and guides and ensure the shower is rinsed off to avoid residue build up.

Weather Seals and Drip Strips

Can be removed if required for cleaning, and can be replaced when they no longer look their best. Refer to the spare parts and accessories section of our website for more details.

Note - If the Glass has been treated follow specific cleaning instructions from the system provider.